



FACEBOOK : @kolinphilippines
INSTAGRAM: @kolinphilippines
YOUTUBE: @kolinphilippines
TIKTOK: @kolinPhilippines

Primus Gold

USER MANUAL FOR SMART CONTROLLER

MODELS:

KSG-IWF-10WFY-8KIM32

KSG-IWF-15WFY-8KIM32

KSG-IWF-20WFY-8KIM32

KSG-IWF-25WFY-8KIM32

KSG-IWF-30WFY-8KIM32



Thank you for choosing a Kolin compatible system.

Providing you the best cooling experience is always our top priority. Thanks to the highly advanced WIFI technology built into your Kolin air conditioning unit that helps in managing your cooling comfort more quickly and easier all in through your smart phone.

EWPE smart app helps manage the cooling operation of your Kolin air conditioning unit anywhere and anytime with ease using your smart phone. Operation can be possible through WIFI and mobile data connection. EWPE smart application is compatible with devices using standard android or IOS operating systems.

IMPORTANT NOTE

Read carefully first the indicated instructions before connecting your WIFI module to the EWPE application. Please make sure to keep this manual for future reference

CONTENTS

SPECIFICATIONS	3
PRECAUTIONS	3
DOWNLOAD AND INSTALLATION OF THE APP	5
USER REGISTRATION	5
NETWORK CONFIGURATION	10
ADDING OF DEVICE MANUALLY	17
STARTUP AND OPERATION OF THE APP	26
SPECIAL FUNCTIONS	26
OPERATION MODES	34

1. SPECIFICATIONS

Model: GRJWB04-J

Frequency Range: 2412-2472 MHz

Maximum RF Output: 18.3 dBm

Modulation Type: DSSS, OFDM

Ratings: DC 5V

Channel of Spacing: 5 Mhz

2. PRECAUTIONS

➤ Operating System Requirement:

 iOS system supports **iOS 7 and above only.**

 Android system supports **Android 4 and above only.**

➤ Please keep your EWPE smart application up to date with the latest version.

- Due to some situations, we affirm: not all Android and iOS systems are compatible with the EWPE smart app. We will not be liable for any issue as a result of the incompatibility.

WARNING!

Due to different network situation, control process may time-out in some occasions. If this occurs, the display between board and the EWPE smart app may not be the same, because of the following.

- Request time-out could happen due to different network situation. Hence, it is mandatory to do network configuration once again.
- The EWPE smart app system is subject to update without prior notice due to some product function improvement. The actual network configuration process shall prevail.
- WIFI signal must be strong in order for the air conditioning unit to work properly with the EWPE smart app. If the WIFI connection is weak in a place wherein the air conditioning unit is placed, usage of repeater is advised.

3. DOWNLOAD AND INSTALLATION OF APP

- For android users, go to Google Playstore, search for “**EWPE Smart Application**” then install.
- For iOS users, go to App store, search “**EWPE Smart Application**” then install.



EWPE ICON

4. USER REGISTRATION

- Ensure first that your mobile device is connected to the internet before proceeding to registration and network configuration.

NOTE

After installing the EWPE Smart Application in your mobile device, a pop-up notification messages will appear. Just click **“Allow”** and **“Agree”** to run the app.

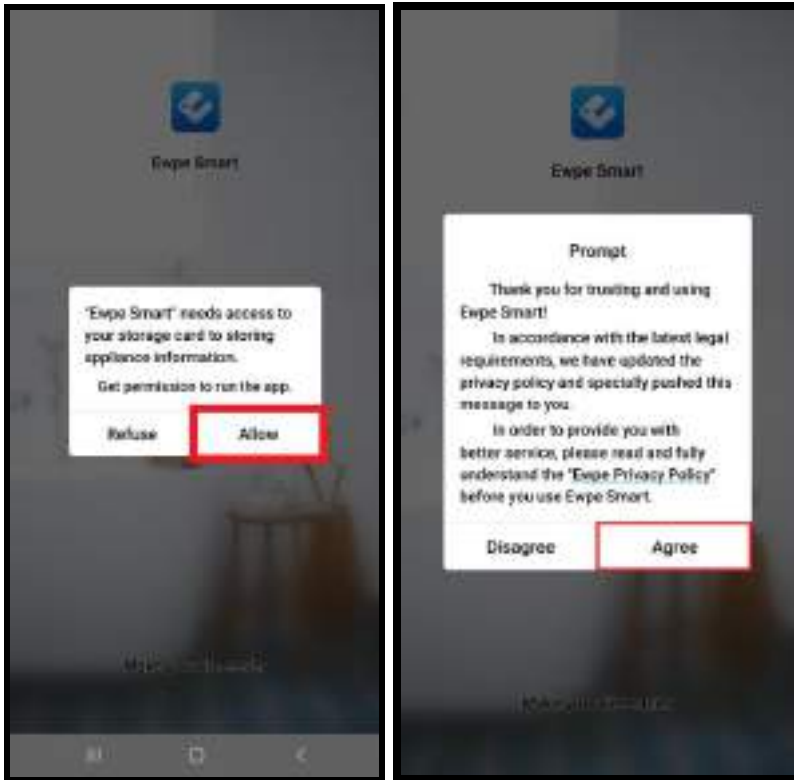

FOLLOW THE STEPS BELOW:

STEP 1: Signing up

- Upon proceeding, click **“Sign up”**.



STEP 2: Fill up the information needed then click “Sign up”

Sign up

Area

KolinPhilippines

KolinPhilInc@gmail.com

..... Type

..... Type

Sign up

I have read and agreed Ezepe Smart App User Registration Agreement and Ezepe Privacy Policy

STEP 3: Click “Got it”

After a successful registration, tap “**Got it**” to proceed.



6. NETWORK CONFIGURATION

WARNING!

- Ensure first that your mobile device is connected to the internet before proceeding.
- Check first the strength of the connection of your wireless network. Also, make sure that the mobile device's wireless function works well and can be connected back to your original wireless network automatically.

NOTE

- Android and iOS has the **same network configuration process**.
- More complex guide is available in the **Help Section**.
- The “**virtual aircon**” shown at the home page is just a **display**, so please do not be confused.

READ CAREFULLY AND FOLLOW THE INDICATED INSTRUCTION BELOW

STEP 1: Adding the device

- At the upper right, tap the “+” symbol to add device



STEP 2: Resetting of AC WIFI

- The air conditioner unit must be **PLUGGED-IN** and in **OFF STATUS** first before resetting of AC WIFI.
- Press “**Mode**” and “**WIFI**” on the remote controller at the same time for **1 second**.
- Once you hear a **beep sound** in your air conditioner unit, it indicates that the reset is successful.
- Click the device icon.

Device
Icon

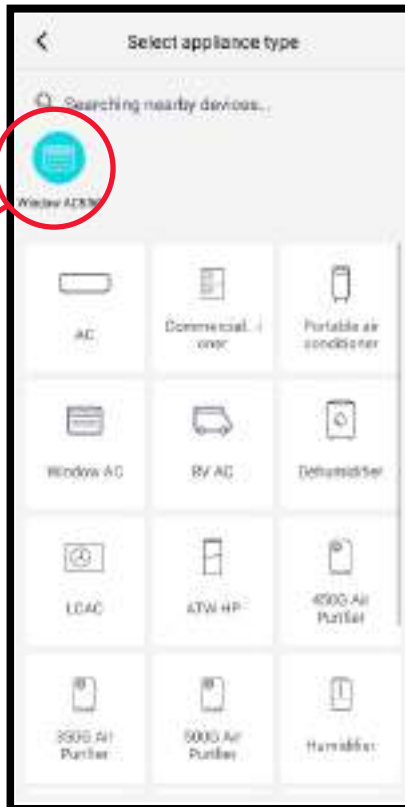

STEP 3: Input WIFI password then tap “Search Device”



NOTE

The name of your WIFI will be automatically determined. If not, restart your WIFI.

STEP 4: Wait the EWPE app to detect your AC.

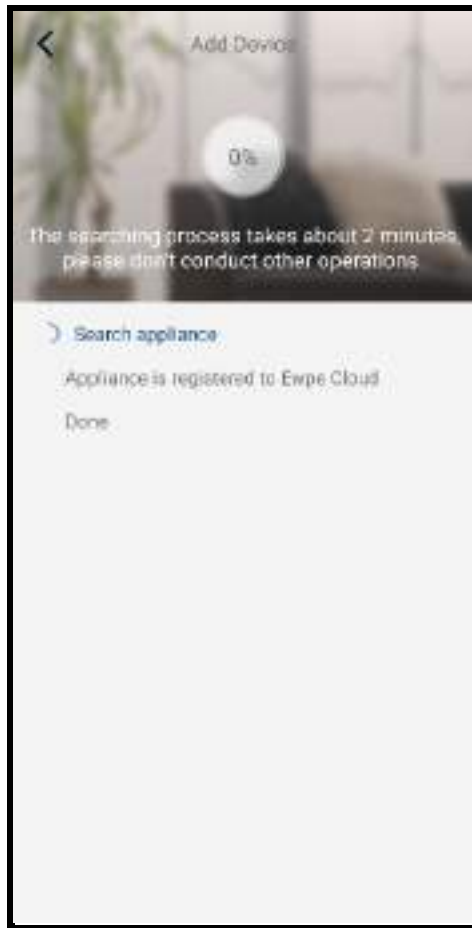

STEP 5: Network Configuration Successful

Tap “**Done**” to finish the configuration.

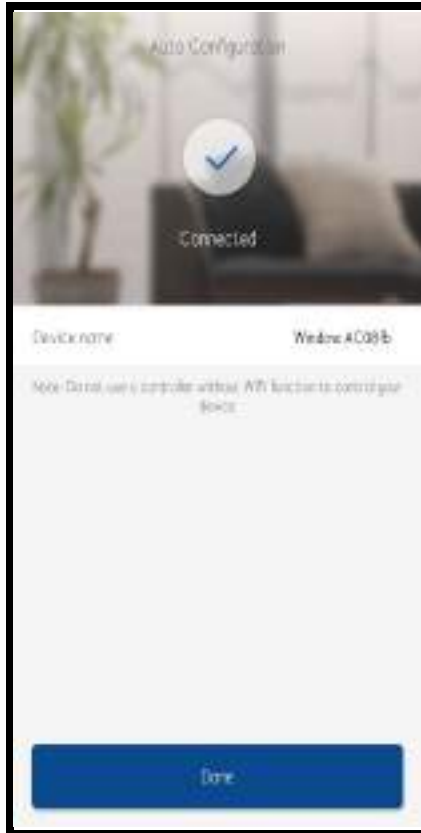

NOTE

Device name may differ per unit.

STEP 6: Check if your AC is added to the list.

Return to the home page to check if your air conditioner is now ready-to-use.

NOTE

- If the “*virtual aircon*” was changed to your specific device name then, it indicates that the configuration was successful.
- If slow connection occurs, just refresh the app by **swiping downwards**.



7. ADDING THE DEVICE MANUALLY

If ever you're experiencing slow internet connection, you can add the device through manual procedure. Wherein, you can connect your phone to the AC through the hotspot of the unit.

STEP 1: Adding the device

Tap the “+” symbol at the upper right corner of the app to add a device.



STEP 2: Select “AC”



STEP 3: Tap “Confirm” to reset the AC WIFI

- Make sure first that your air conditioner device is **PLUGGED-IN** and in **OFF STATUS**.
- Press **“Mode”** and **“WIFI”** at the remote for the same time for **1 second**.
- Click **“Confirm”**

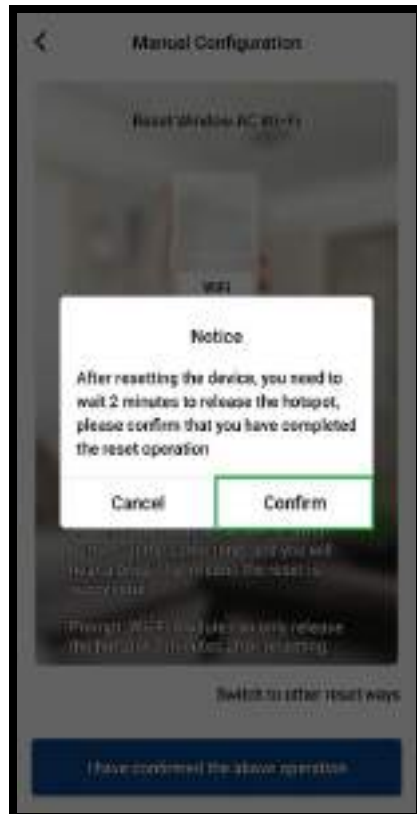

STEP 4: Tap “Next”

Wait for the loading to complete then tap “Next”



STEP 5: Selecting Wireless Network

After the WIFI hotspot of the air conditioner appears, tap **“Next”**.



NOTE

If there are no wireless networks appeared, go back again to step 5.

- Choose home wireless network and input WIFI password. Click "Next".



NOTE

If ever these notifications show up, just click **“connect”**.

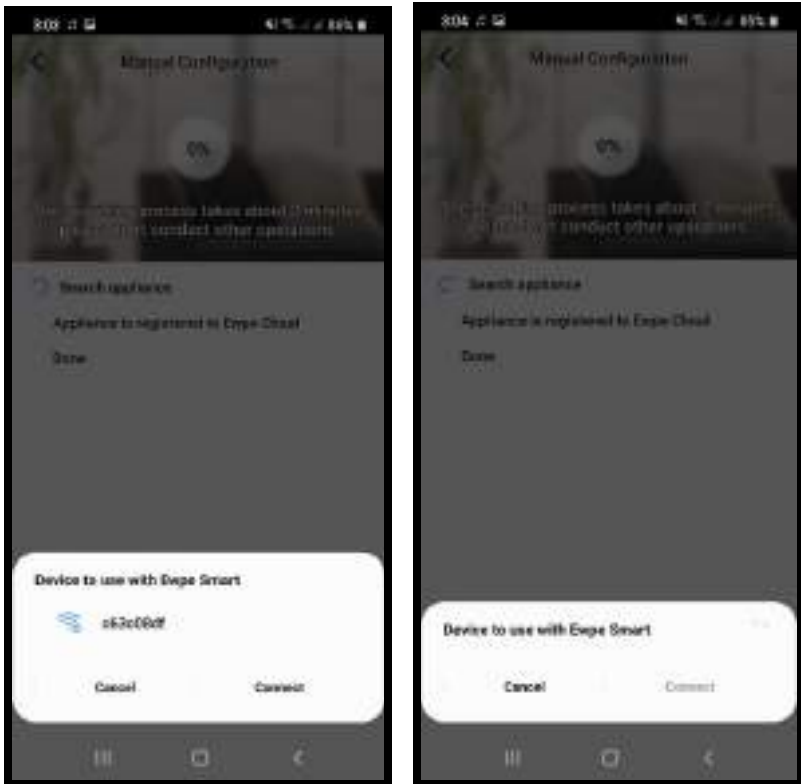

STEP 6: Network Configuration Successful

- Upon proceeding, EWPE app will now search for your AC.
- Click **“Done”** after a successful configuration.

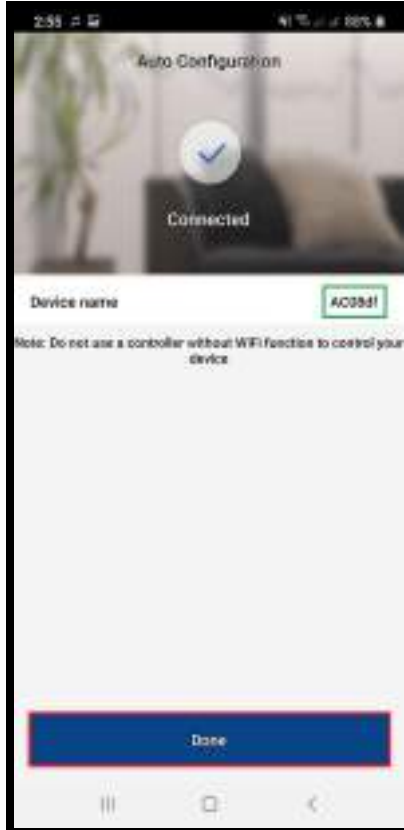
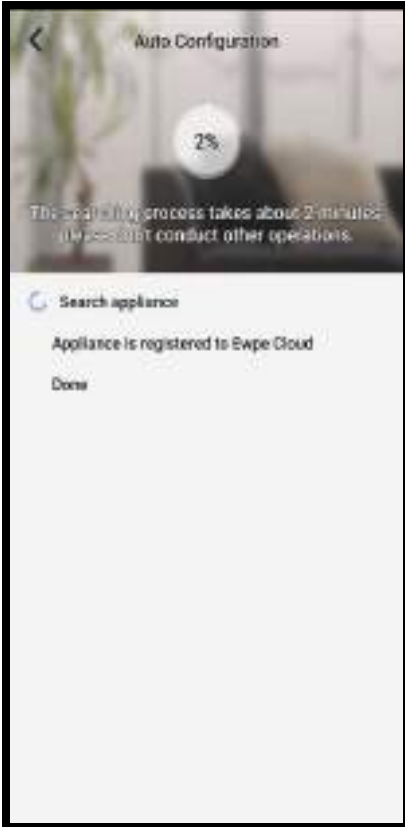

STEP 7: Check if your AC is added to the list.

Return to the home page to check if your air conditioner is now ready-to-use.

NOTE

- If the “*virtual aircon*” was changed to your specific device name then, it indicates that the configuration was successful.
- If slow connection occurs, just refresh the app by **swiping downwards**.



8. STARTUP AND OPERATION OF THE APP

Through EWPE smart application, the user can control the air conditioners' on/off status, fan speed, temperature setting, special functions, and operation mode.

NOTE

Please ensure first that both of your mobile device and air conditioner is connected.

SPECIAL FUNCTIONS

Special functions located at the bottom of the application. Function such as "Air" and "80C heating" is not applicable.

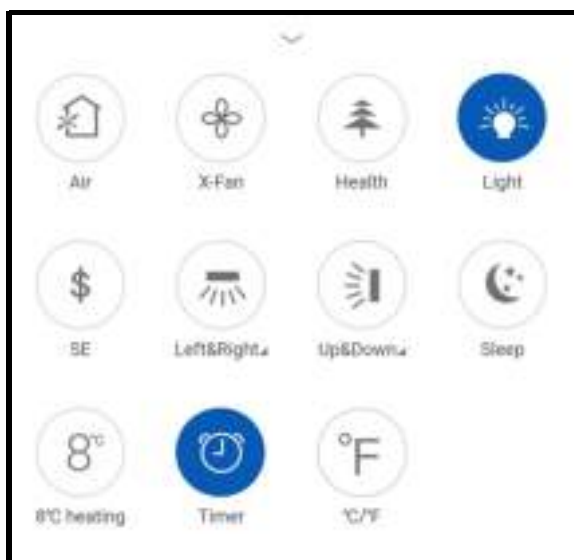

X-FAN

After turning off the unit, the blower will continue to operate for 2 minutes to dry the evaporator when activated.

- To activate, click the “**X-Fan**” icon.

HEALTH

The Cold Plasma Technology feature will activate. It will enhance the air quality by removing harmful air contaminants.

- To activate, click the “**Health**” icon.

LIGHT

It controls the (on/off) settings of the LED lights.

- To activate light mode; go to function button → then tap “**Light**”.

SE

The AC will set to 27 °C and auto fan setting for optimum saving of energy.

- To activate save energy feature, click the icon.

UP & DOWN

The horizontal louver can either swing up and down or fixed to a certain position.

- To activate up and down swing, click the icon.
- To fix the louver's position, click the drop down button.

LEFT & RIGHT

The louver can swing from left to right or fixed to a certain position.

- To activate left and right swing, click the icon.
- To fix the louver's position, click the drop down button.

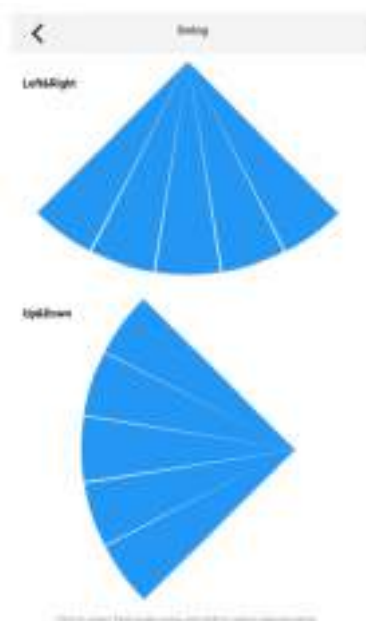

The louver can swing from left to right or fixed to a certain position.

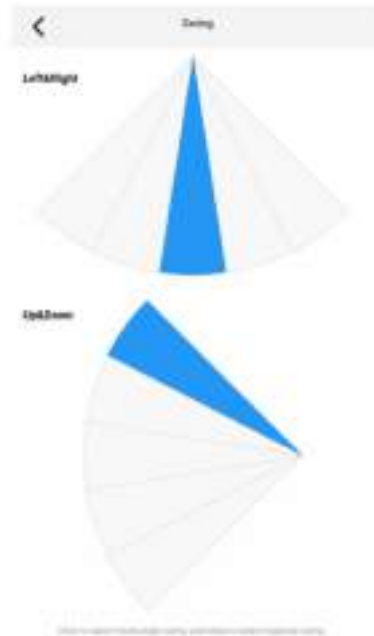

SLEEP

Sleep mode helps to provide the best cooling comfort while the user sleeps by increasing its temperature every one hour in 2 hours to avoid excessive coldness during the user's ongoing sleep.

- To activate sleep mode; go to function button → then tap "**Sleep**".

TIMER / PRESET

- The user can operate to (turn on / turn off) the air conditioner on preferred schedule. The user can also save any settings for that preferred schedule.

Adding Preset

- Tap “**Function Button**” located at the lower left of the app.

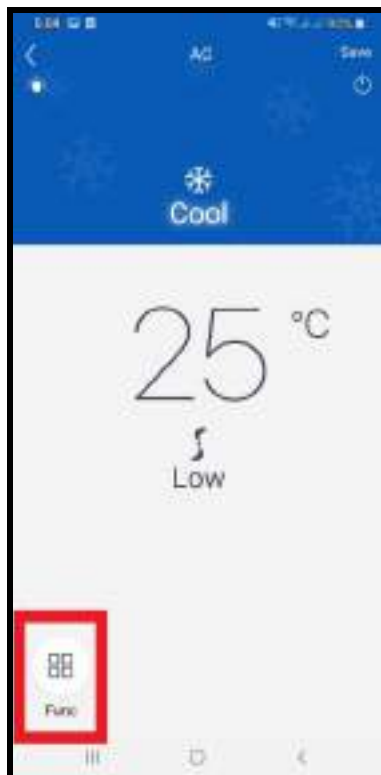

➤ Then tap the **“Timer”** icon

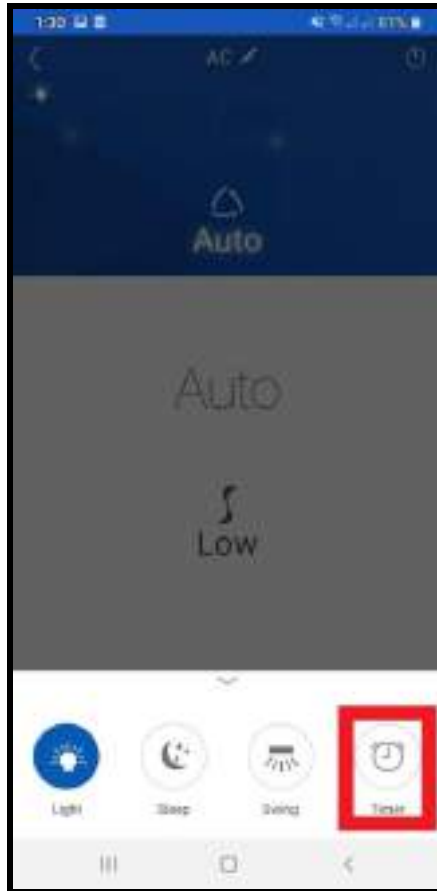

- Setup your preferred schedule for your AC then click **“Save”**.

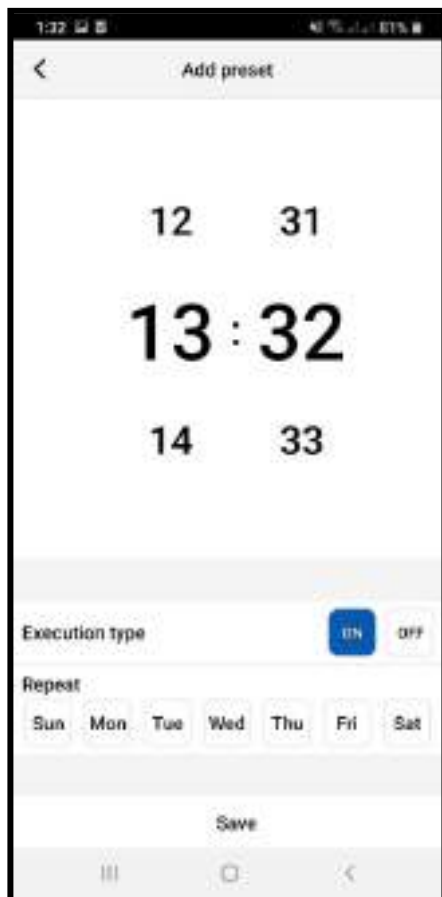

NOTE

- On adding preset, **swipe up or down** the time you preferred to operate your AC.
- On execution type, tap **“on”** and **“off”** to select the status of your AC.

- The user's preferred schedule can be repeated everyday or in any selected days by tapping the days shown.

Preset List

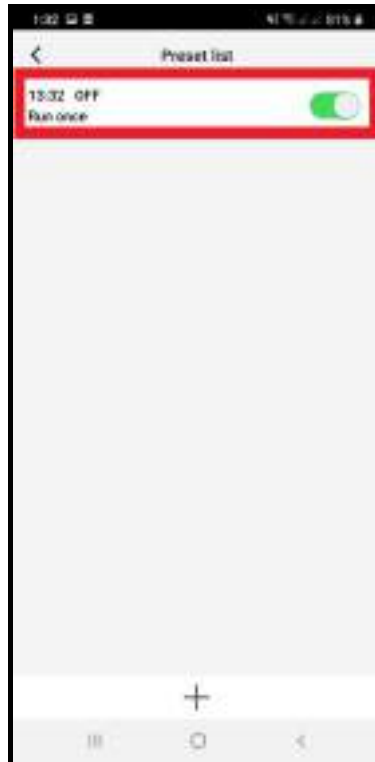

- Then, the preferred schedule will be shown at the **preset list**.

°C/°F

The user can change the unit of temperature display from Celcius to Farhenheit, vice-versa.

OPERATION MODES

- Operation mode has (Cool/Auto/Fan/Dry) that can be controlled through **swiping the operation icon**.
- **Swipe the temperature icon** to also control the temperature settings.

Cool Mode



Auto Mode



25 °C

Auto



Func



Auto

Auto



Func



Dry Mode



Fan Mode



NOTE

Heat mode is not applicable.

FAN SETTINGS

The user can use four different settings in fan mode (**swipe left or right the fan icon to control fan settings**).

Low Fan Mode



Medium Fan Mode



High Fan Mode



Auto Fan Mode



PROFILE SECTION

- Profile section is located at the profile logo (Upper left of the homepage).
- Six available features can be use; group control, home management, messages, help, feedback and settings.

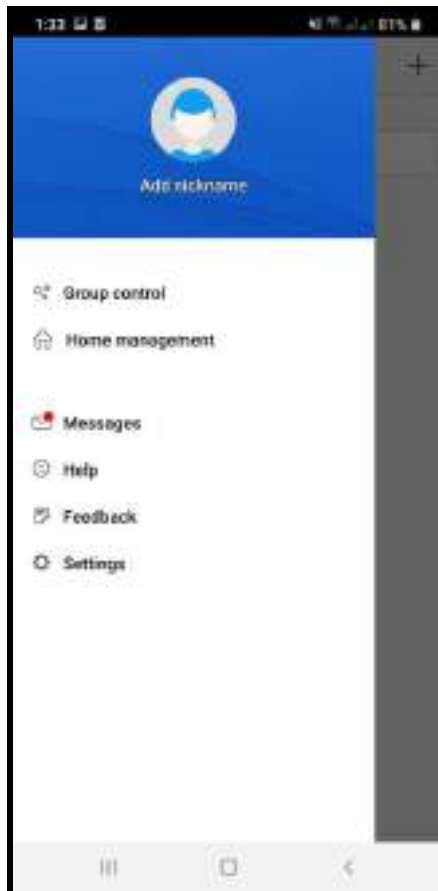

1. GROUP CONTROL

➤ Home Control

It serves as shortcut settings to activate the preferred cooling settings that the user wishes to use immediately when **at home**.

➤ Away Control

It serves as shortcut settings to activate the preferred cooling settings that the user wishes to use immediately when **away from home**.



Setting up Group Control

- Under group control, tap “**edit**”

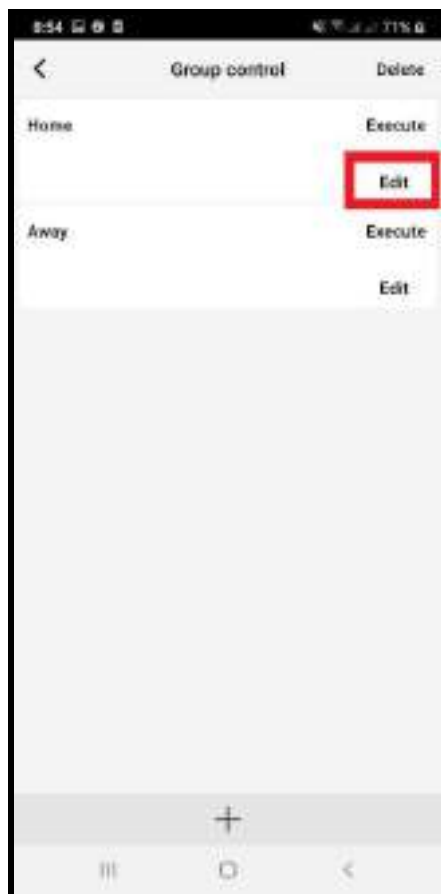

- Now click “**AC**” then “**Settings**”

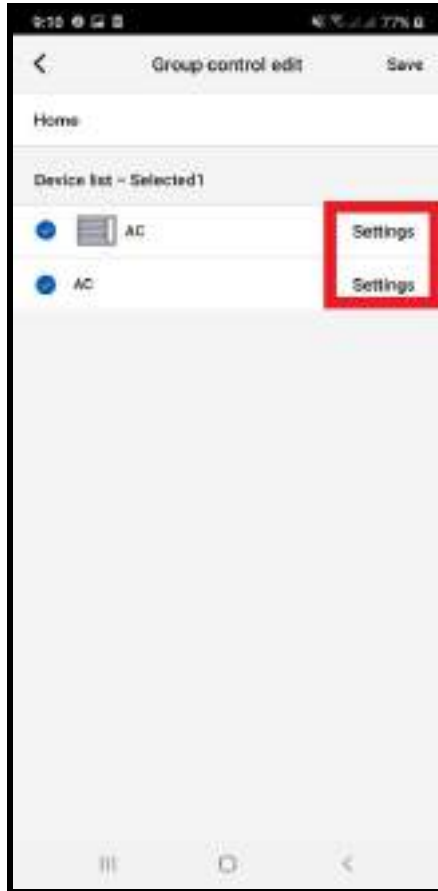

- You can now customize your preferred cooling settings e.g; Cool mode, low fan setting, lights on, Swing, and at 16°C and after customizing, click “**Save**”.



NOTE

- **Same procedure** also goes when customizing for group control-away.
- When using away control, make sure that your air conditioner unit is **ON**.

- After saving, your preferred cooling settings will appear at the **group control list** under homepage.



NOTE

- You can also add more cooling settings by clicking the “+”.

- Return at the home page and select your saved settings by tapping “**Home**” or “**Away**”.



NOTE

- Tap “**home**” if you saved it at home
- Tap “**away**” If you saved it at away.

2. HOME MANAGEMENT

Home Management function enables the air conditioner to be controlled by multiple mobile phones by creating a group called **family**.

Inviting a Family Member

- Go to “**Home management**” under the profile section.

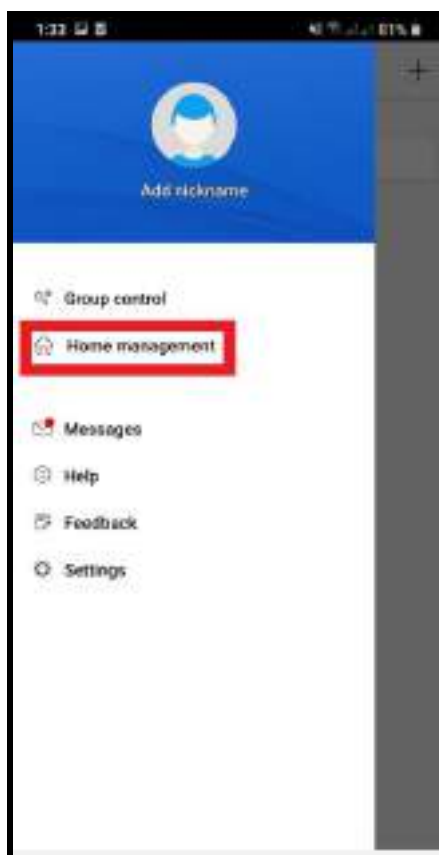

- Then tap **“My Home”**

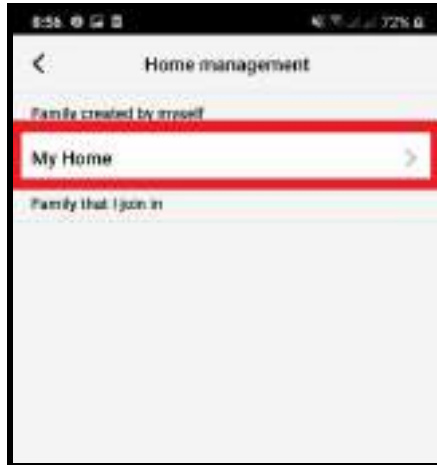

- Click **“Invite member”** then input **the username / email** of the family member you wish to invite.

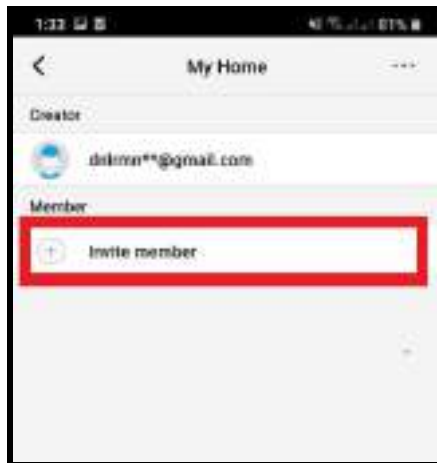

- Go back to homepage and tap the “**my home**” to view your family.



NOTE

- If the main user was disconnected then all the invited members in the family are **also disconnected**.
- For more organized operation, only the main user has the authority to invite other members to join the family.

MESSAGES

The Messages feature notifies the incoming information to the user about the status of the AC and the app.



HELP SECTION

- In Help Section, it assists the user in 3 different types of help categories. The three help categories presented are; **account, appliance and others.**

Account Category



Appliance Category



Others Category



FEEDBACK

It indicates where the customer's reviews and suggestions can be address towards to the application.

SETTINGS

- Enable vibration alert feature to notify the user of any incoming messages that the app the AC encounters.
- About feature pertains to the version of the EWPE app.

Company will not be liable for any issues and problems caused by the internet, wireless router and smart devices. Please contact the original provider to get further assistance.

If you have any concerns, please contact us at the following:

Customer hotline: **(02) 8852-6868**

Text hotline: **(0917)-811-8982**

Email: **customerservice@kolinphil.com.ph**

Also, please like and follow us on our following social media accounts:

Facebook: **Kolin Philippines**

Instagram: **kolinphilippines**

Youtube: **kolinphilippines**

KPII111722



Kolin Phils. Int'l., Inc. SERVICE CENTERS

BRANCH	ADDRESS	TEL. NO.
Bacolod	Door #A-2 & A-3 UTC Bldg., Alunan St., Brgy. Singcang, Bacolod City	(034) 433-0031
Cagayan De Oro	Door #3 De oro Land Bldg., Julio Pacana St., Puntod, Cagayan De Oro City	(088) 856-4672
Cebu	Unit #6 A. Geson Bldg., D. Jakosalem cor. F. Ramos St., Cebu City	(032) 253-9997 / (032) 253-7944
Dagupan	Unit #1107 Caranglaan District, Dagupan City Pangasinan	(075) 523-2832
Davao	Blk 17 Lot 9, Calamansi St., Juna Subd., Matina, Davao City	(082) 227 - 7063
Iloilo	Door #4 D' Appliance Arcade, South Fundidor, Moli, Iloilo City	(033) 336-1970
Pampanga	LRK Commercial Bldg., Jose Abad Ave., Lagundi Mexico, Pampanga	(045) 455-2934

For More air conditioner tips, please like, share and follow us on our social media accounts:

Facebook: [kolinphilippines](#)
Instagram: [kolinphilippines](#)
Youtube: [kolinphilippines](#)
Tiktok: [kolinphilippines](#)
Website: www.kolinphil.com.ph

OFFICE

Kolin Bldg., 1854 Sta. Rita St.,
Guadalupe Nuevo, Makati City
Service Hotline: (02) 8852-6868

PLANT

Blk 3 Lot 5, Main Drive First Cavite
Industrial Estate, Langkaan 1,
Dasmariñas City, Cavite
Tel. No.: (046) 402-0793