

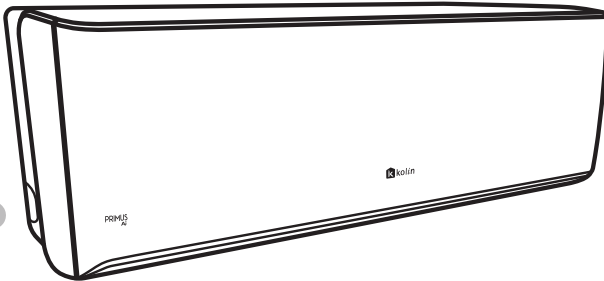

PRIMUS Ai

Full DC Inverter Split Type Air Conditioner

SMART CONTROLLER MANUAL



MODEL:

KS-IW10-GPAI13P1M32
KS-IW15-GPAI13P1M32
KS-IW20-GPAI13P1M32
KS-IW25-GPAI13P1M32
KS-IW30-GPAI13P1M32

Thank you for purchasing our air conditioner. Please read this manual carefully before operating your new air conditioning unit. Make sure to save this manual for your reference.

CONTENTS

SYSTEM REQUIREMENTS.....	2
PRECAUTIONS.....	3
DOWNLOAD AND INSTALLATION OF APP.....	4
USER REGISTRATION AND SIGN-IN.....	5
• Creating Account.....	5
• Signing-In.....	6
INITIAL SETUP.....	7
NETWORK CONFIGURATION.....	8
• Connecting App to AC Device.....	8
◦ via Automatic Discovery.....	9
◦ via Manual Setup.....	11
HOW TO USE THE APP.....	15
• Home Display Page.....	15
◦ Device Control Interface.....	16
◦ Device Features and Controls.....	17
• Schedule.....	25
• Energy.....	26
• Account.....	28
◦ Invite Members.....	30
◦ Home Management.....	31

SYSTEM REQUIREMENTS

A. Wi-Fi Requirements

- **Wi-Fi Frequency**

- This device supports connectivity to 2.4 GHz Wi-Fi networks only. 5 GHz Wi-Fi networks is not supported.

- **Signal Strength**

- Ensure a strong and stable network connection near the AC for proper operation.

B. Smartphone Requirements

- **Operating System**

- Android 6.0 or later
- iOS 12.0 or later (iPhone/iPod touch), macOS 11.0 later (Mac)

- **Other requirements**

- Your phone should have camera access (for QR code scan).
- Stable internet connection
- Sufficient storage space to install and update the app.

NOTE: Make sure the EWPE Smart app is updated to the latest version to ensure compatibility and feature availability.

PRECAUTIONS

GENERAL SAFETY

- Only operate the air conditioner and smart controller as described in this manual.
- Do not disassemble, modify, or tamper with the smart controller or AC unit.
- Keep the controller and connected devices away from water, moisture, or heat sources.
- If the unit or smart kit appears damaged or faulty, stop using it immediately and contact Kolin Service Hotline or its Authorized Service Partners.

CONNECTIVITY & WI-FI REQUIREMENTS

- The EWPE Smart app only supports 2.4 GHz Wi-Fi networks only.
- A strong and stable internet connection is required when connecting the app to the AC. The network should remain within range of the AC at all times to ensure proper control. Once the connection is established, the smartphone does not need to stay on the same Wi-Fi network used during setup.
- Using Public Wi-Fi is not recommended due to potential security risks.
- If the app frequently disconnects, check for internet instability or signal interference.
- A stable internet connection is a requirement for the system.

DEVICE USAGE

- Do not share your account credentials with untrusted users.
- Avoid changing AC settings from multiple devices at the same time to prevent command conflicts.
- Changes made in the app may not be reflected on the physical remote control.

DURING SETUP

- Allow all necessary app permissions, especially for location, camera, and Bluetooth.
- Ensure your smartphone's Bluetooth and location services are turned on if using Bluetooth setup.

SYNC DELAYS

- In weak network conditions, app commands may take time to reach the AC.
- If status doesn't update right away, try refreshing the app or restarting the AC.

DOWNLOAD AND INSTALLATION OF APP

NOTE: Ensure your device have...

- ✓ Available storage space
- ✓ Strong and stable Wi-Fi network or has an active mobile data connection.



Depending on your phone's operating system, you can download the **EWPE Smart** app through the following methods:



FOR ANDROID PHONE USERS:

Open the **GOOGLE PLAY STORE** on your device, type "**EWPE Smart**" in the search bar, then select the app from the results and tap "**Install**" to download it.



FOR IOS PHONE USERS:

Open the **APP STORE** on your device, type "**EWPE Smart**" in the search bar, then select the app from the results and tap "**Install**" to download it.

OR

Scan this QR code, and tap "Install" to download it.



USER REGISTRATION AND SIGN-IN

NOTE: *Ensure your device have...*

- ✓ *Strong and stable Wi-Fi network or has an active mobile data connection.*

- When you first open the app, a message will appear. Please review the Privacy Policy and User Agreement, then tap "Agree" to proceed. Next, you'll see a few introductory slides highlighting the app's features; swipe right to view them. After the last slide, you can either "Skip" to continue, or "Register" to create account or "Sign In" to your existing account.

CREATING ACCOUNT

- ① Tap "Register" to start.
- ② Select Your Region (e.g., the Philippines).
- ③ Enter a unique username.
- ④ Provide an active email address.
- ⑤ Create a secure and strong password.
- ⑥ Agree to Terms.
- ⑦ Get a verification code by tapping the "Obtain the verification mode" button.
- ⑧ Check your email for a 6-digit code.
 - *Check spam if not in inbox.*
 - *If no email, wait 60s then tap "Regain."*
- ⑨ Enter the code in the app. Once confirmed, you can now access the app.

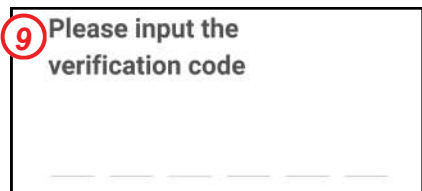
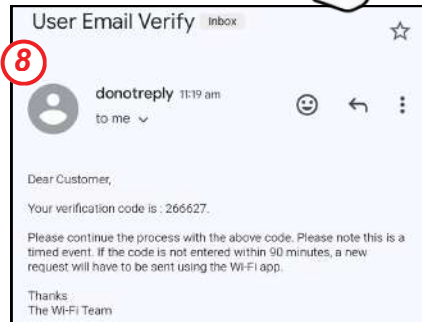
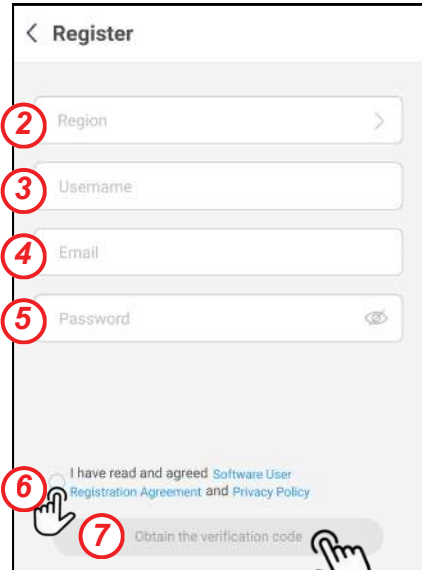

If you already have an account, simply sign in with your email and password.

SIGNING IN

- ① Tap "Sign In" on the main screen.
- ② Enter your username or email.
- ③ Enter your password.
- ④ Select your region (e.g., the Philippines).
- ⑤ Agree to terms.
- ⑥ Tap "Sign In" to access your account.

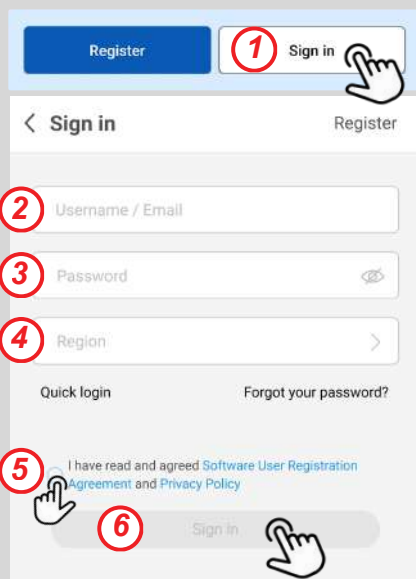

For Quick login, it is an alternative way to log-in your account without using password.

Quick login

1. Tap "Quick Login" on the sign-in page.
2. Enter your email address.
3. Select your region (e.g., the Philippines).
4. Agree to terms.
5. Tap "Obtain the Verification Code".
6. Check your email for the 6-digit code
7. Enter the code in the app.

If you don't remember your password, click on "Forgot your password?" to set new password.

Forgot password

1. Tap "Forgot your password?" on the sign-in page.
2. Enter your email address.
3. Select your region (e.g., Philippines).
4. Tap "Obtain the Verification Code".
5. Check your email for the 6-digit code
6. Enter the code in the app.
7. Set a new password and confirm it.
8. Tap "OK".

INITIAL SETUP



Home Display Page

The screenshot shows the KolinAC Home Display Page. At the top left is the account name 'KolinAC'. To its right are a messages icon and an add device '+' button. Below this is a 'Welcome to Ewpe Smart' banner with a 'Click to view' button. Underneath is a room management section with tabs for 'All', 'Living Room', 'Bedroom', and 'Kit'. The main area displays a 'Virtual air conditioner' control panel showing '16°C' with minus and plus buttons. At the bottom is a navigation bar with 'Home', 'Schedule', 'Energy', and 'Account' icons.

- Account Name**
- Messages**
 - It contains all messages by the system and device
- Add Device**
 - Tap the "+" button to pair a new smart device.
- Welcome to EWPE Smart**
 - Tap "Click to view" to access the Help page and view the instructions for using the app.
- Room Management**
 - Manage and organize your devices within the app using this feature.
- Virtual Air Conditioner**
 - Preview the control panel of the device.

- How do I connect my device to the APP
- How do I remotely control my device with an APP
- How do I invite someone to control a device

Note: This is only a simulated view of the control panel and its functions. You cannot control any device from this page. Not all features shown in the virtual air conditioner are applicable to your selected device. Please connect to your actual device to view and access its control panel.

NETWORK CONFIGURATION

Precaution:

The illustrations in this manual are for reference only. The actual screens displayed on your device may vary depending on factors such as your phone's operating system, network connection, and the app version. Therefore, certain steps may not be available on your device.

NOTE: Make sure...

- ✓ Air conditioner is plugged in.
- ✓ When **connecting APP to Air Conditioner**, both the AC unit and the smartphone should connect to the **same WiFi network**.
- ✓ The network must operate on 2.4GHz frequency band only.
- ✓ Wi-Fi signal is strong and stable near your AC.
- ✓ All necessary permissions are allowed (**bluetooth, location, WiFi, etc.**)

From the EWPE Smart app home display, you can connect the app to the AC unit.

CONNECTING APP TO AC Device

There are two ways to connect the app to AC Device:

A CONNECTING THE EWPE SMART APP TO THE AIRCONDITIONER VIA AUTOMATIC DISCOVERY

1. To connect the application to the air conditioner, the Wi-Fi of the unit must first be reset. Follow the instructions below to reset it:

1.1

PLUGGED IN and **POWER OFF** the unit to enter standby mode



1.2

Aim the remote at the unit



1.3

Press and hold the **WIFI** and **MODE** button together

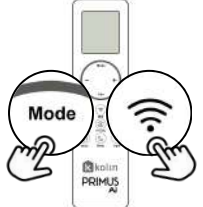

1.4

Wait for a beep sound to confirm reset.



NOTE: The WiFi hotspot used to connect the app to the air conditioner only appears for a short time. Make sure to connect the app to the AC quickly. If the hotspot disappears, reset the WiFi and try connecting again.

A CONNECTING THE EWPE SMART APP TO THE AIRCONDITIONER VIA AUTOMATIC DISCOVERY

2. From the EWPE Smart app's home page, tap the “+” button to add a device.

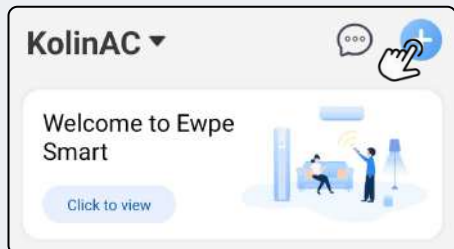

3. A prompt will appear asking for permissions. Allow all necessary permissions for a smooth setup.

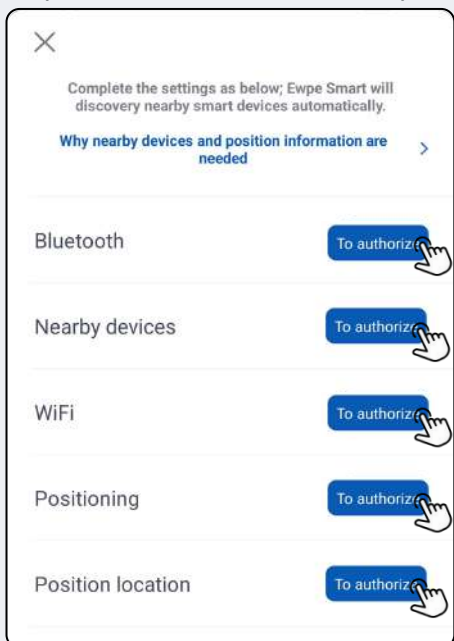

NOTE: However, if all necessary permissions have already been granted, this step will be skipped.

4. After granting all required permissions, the app will automatically search for the device. Once found, tap it to continue. If not found, reset the WiFi and try again.

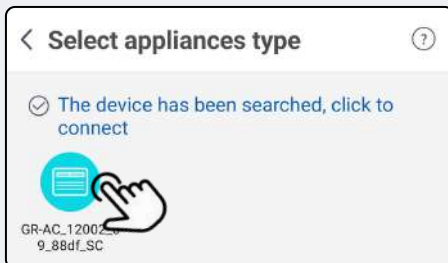

NOTE: The reset process may take time on some devices. Wait at least 2 minutes for the AC's hotspot to appear. If it doesn't, try resetting again.

5. After tapping the device, you will need to confirm your home WiFi network. Select WiFi, then enter your password, and finally, tap “Next”.



NOTE: This device supports connection to 2.4GHz network only. 5GHz networks are not supported.

A CONNECTING THE EWPE SMART APP TO THE AIRCONDITIONER VIA AUTOMATIC DISCOVERY

6. Next, the app will connect to the AC. Wait until the process is complete.

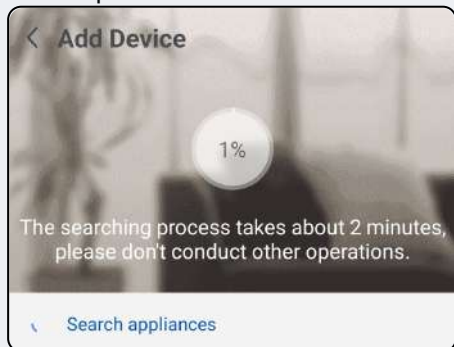

7. After the connection, rename the device and choose its room. Tap **“Try it now”** to control the device, or **“Done”** to go back to the homepage

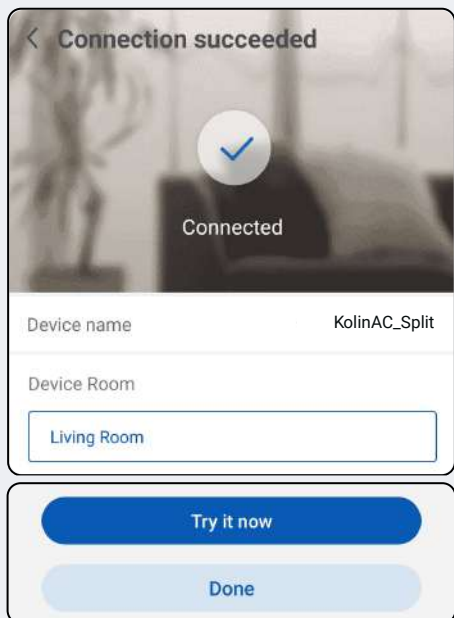

8. The device should now appear on the EWPE Smart app's home display.



NOTE: In some cases, certain features may not appear on the device control screen. If this happens, scroll down on the homepage to refresh all devices.

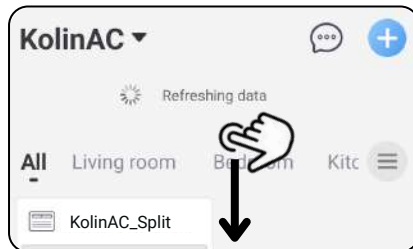

If the features still do not appear, close and reopen the app. If the issue persists, reconnect the app to the air conditioner.

After successfully connecting APP to the AC Device, proceed to page 15 to see **How to Use the App**.

B

CONNECTING THE EWPE SMART APP TO THE AIRCONDITIONER VIA MANUAL SETUP

1. From the EWPE Smart app's home page, tap the “+” button to add a device.

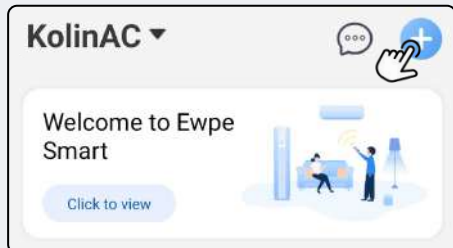

2. A prompt will appear asking for permissions. **Allow all necessary permissions** for a smooth setup.

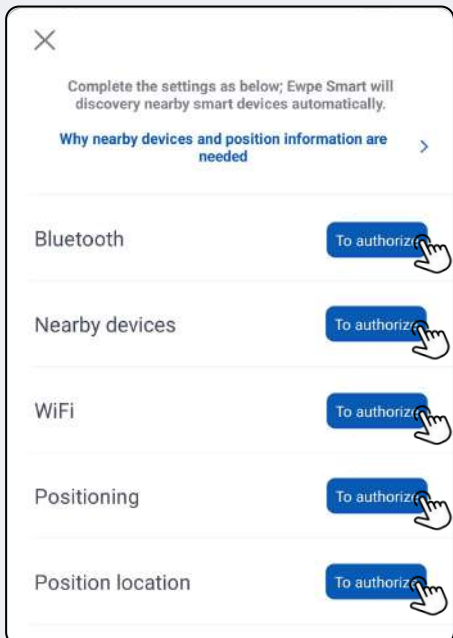

NOTE: However, if all necessary permissions have already been granted, this step will be skipped.

3. To **add a device manually**, select appliance type by **tapping on the category of your device**.

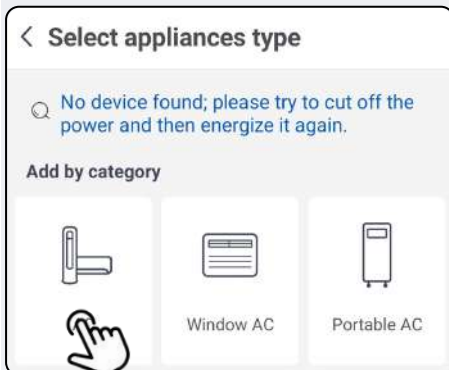

4. A page will appear displaying instructions to **reset the Wi-Fi**.

RESETTING THE WIFI

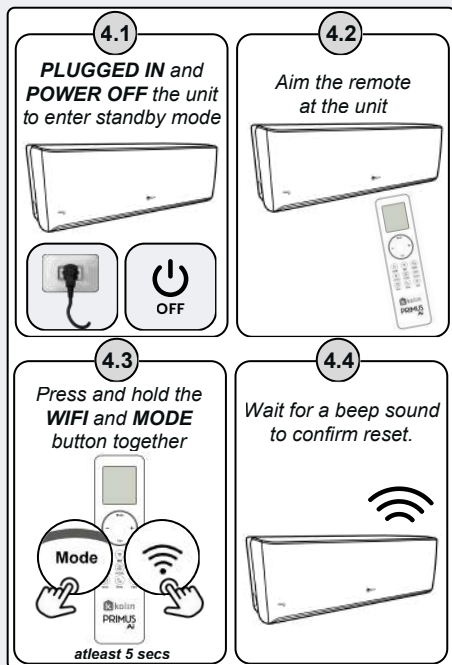

B

CONNECTING THE EWPE SMART APP TO THE AIRCONDITIONER VIA MANUAL SETUP

5. After resetting the WiFi, tap “**I have completed this operation**”, and tap “**Next**” to proceed.



6. Wait for the app to search for the AC. When the device's hotspot is obtained, tap “**Connect**”.



NOTE: The reset process may take time on some devices. Wait at least 2 minutes for the AC's hotspot to appear. If it doesn't, try resetting again.

7. After selecting the device, confirm your home WiFi network, enter the password, and tap “**Next**”.



NOTE: This device supports connection to 2.4GHz network only. 5GHz networks are not supported.

8. Next, connect your phone to the device's hotspot. A page will show the hotspot name and password—take note of them, then tap “**I Know**”.

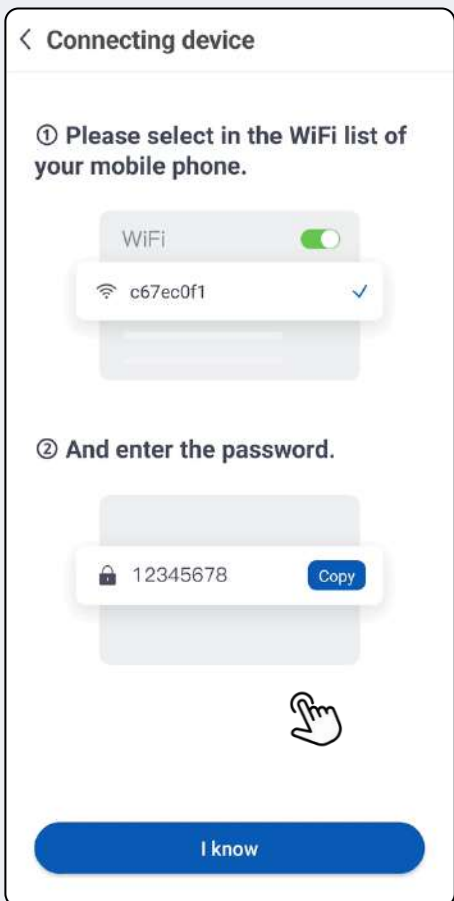

B

CONNECTING THE EWPE SMART APP TO THE AIRCONDITIONER VIA MANUAL SETUP

9. Connect your mobile phone to the device's hotspot. Tap on it and enter the password.

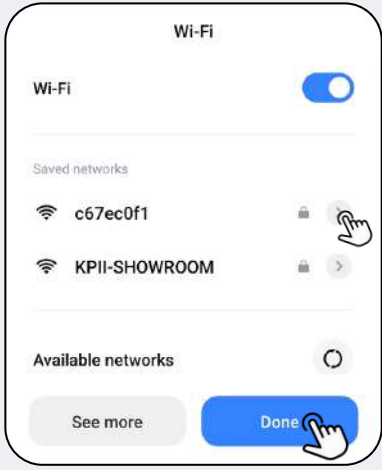

10. After connecting to the hotspot, wait for the device connection to load.

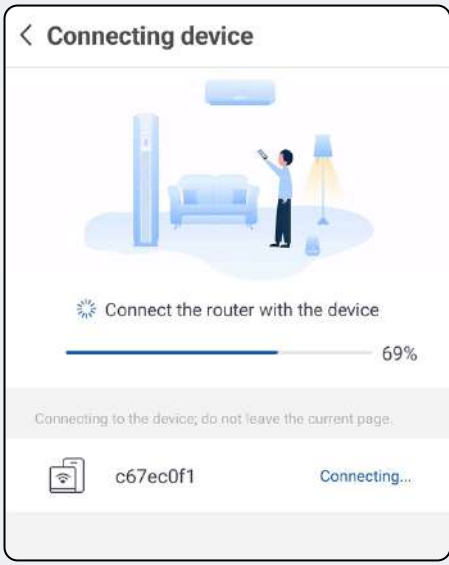

11. Once connected, you can rename the device and select its room location. Tap **“Try it now”** or **“Done”** to complete the setup.

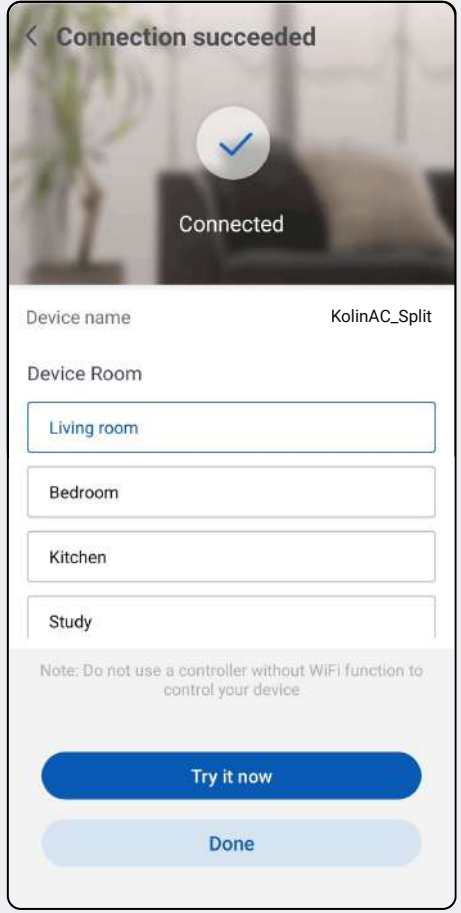

B**CONNECTING THE EWPE SMART APP TO THE AIRCONDITIONER VIA MANUAL SETUP**

12. The device should now appear on the EWPE Smart app's home display.

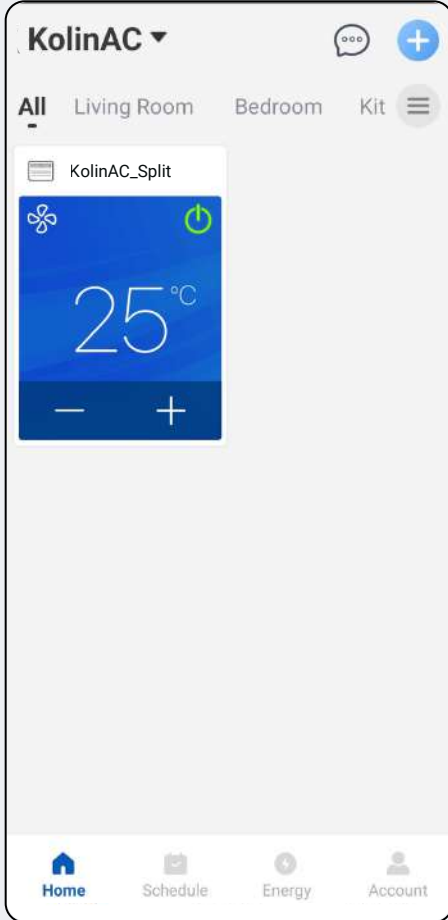

NOTE: In some cases, certain features may not appear on the device control screen. If this happens, scroll down on the homepage to refresh all devices.

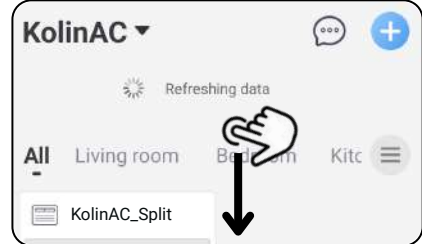

If the features still do not appear, close and reopen the app. If the issue persists, reconnect the app to the air conditioner.

*After successfully connecting APP to the AC Device, proceed to page 15 to see **How to Use the App**.*

HOW TO USE THE APP



Home Display Page



CONNECTED DEVICE

- Tap on this device to open the Device Control interface

Temperature Control

- + Tap this to increase temp
- Tap this to lower temp



Home Page

This page displays all devices connected to the app and provides options for adding or connecting new devices. (see page 15)



Schedule

This section allows you to set schedules or commands for all your connected devices. (see page 25)



Energy

This section displays the summarized energy consumption of your devices with energy data (see page 26)



Account

This section contains your account information, home management options, and member invitation settings. It also includes general app settings and other related functions. (see page 28)

Device Control Interface

Name of the Device

KolinAC_Split

Light

25°C
Indoor Temp

Cool | Auto

25°C

— +

On/Off Mode Wind Wspeed Timer

Device Settings

- Tap this to view device information and settings, including options to change the device name and perform a firmware update, as well as user research and guided

This area displays all the active features. Any feature that is turned on will be shown here.

Indoor Ambient Temperature

Mode | Fan Speed

Set Temperature

Temperature Control

- ➕ Tap this to increase temp
- ➖ Tap this to lower temp

You may also drag the solid circle along the arc to control temperature

Temperature Limits: 16°C - 30°C

Feature Panel

- Here you'll find control features and operational functions of the AC device.

Scroll up this icon to see the feature panel



DEVICE FEATURES AND CONTROLS



Power Button

- Turns the air conditioner on or off.



Mode Button

- Select the desired operating mode:



Cool Mode

- Blows cold air to lower the room temperature based on your set level.



Fan Mode

- Circulates the air in the room without using the cooling function.



Dry Mode

- Reduces excess humidity by removing moisture from the air without significant cooling.



Auto Mode

- Automatically adjusts cooling and fan settings depending on the room's current temperature.

**Heat Mode not functional on this model*

Wind Speed Button

- Adjusts the fan airflow speed (auto, quiet, low, medium-low, medium, medium-high, high, or turbo) and allows control of airflow direction.

WIND SPEED



Auto  Auto



Quiet  Quiet

Low     

Medium-Low     

Medium     

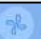
Medium-High     

High     

Turbo  Turbo

WIND DIRECTION



U-D Swing (Up-Down):

- The horizontal louver moves continuously in an upward and downward motion. This creates a vertical wave of air to circulate cooling throughout the entire room height.



L-R Swing (Left-Right):

- The internal vertical fins oscillate automatically from side to side. This fans the air across the width of the space to reach the far left and right corners.



U-D Fixed Angle:

- Pressing this opens a submenu of five buttons to set the horizontal louver's vertical height. You can then select a specific angle to lock the air in your desired direction.



Direction 1 Direction 2 Direction 3 Direction 4 Direction 5



L-R Fixed Angle:

- Pressing this opens a submenu of five buttons to set the internal fins' lateral direction. You can then select a specific angle to lock the air in your desired direction.



Direction 1 Direction 2 Direction 3 Direction 4 Direction 5

Timer

- Set a startup and/or shutdown time to automatically turn your air conditioner on or off based on your preferred schedule.



TO SET A TIMER

1 Tap "Add"



2 Select timing condition



- 3** Choose the Startup Time (when you want the AC to turn ON) and/or Shutdown Time (when you want it to turn OFF).



- 4** When setting the Startup Time, you must also select the Mode, Temperature, and Fan Speed that will apply when the AC turns on.

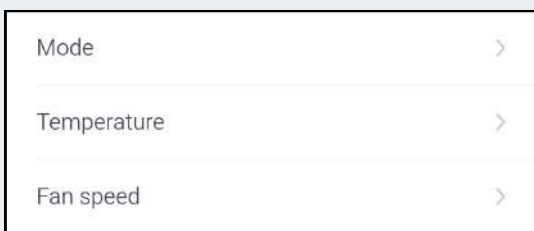

- 5** You can schedule the timer to repeat daily or set it in a custom (self-defined) manner.

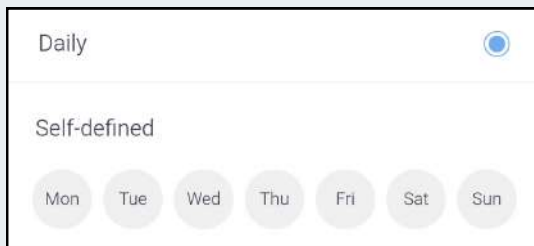

6 Tap “Save” to store the timer setting.

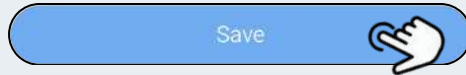

7 Once saved, the timer will appear in the Timer List and will be automatically toggled ON.



Note: You can create multiple timers, but overlapping schedules may interfere with active timers.

Light

- Tap the Light icon to turn the unit's LED light ON or OFF.
- This function allows you to control the display or indicator light on the unit, helping you reduce brightness at night or check the unit's status more easily.

X-Fan

- X-FAN helps remove moisture from the indoor unit after shutdown by keeping the fan running briefly.
- In Cool or Dry mode, tap the X-Fan button to activate it. The indoor fan will continue running for a few minutes after the unit is turned off to help dry the evaporator and prevent mold growth. By default, X-FAN is off when the unit is powered on. This function is not available in Auto, Fan, or Heat modes.

When X-FAN is ON:











- After turning off the unit, the indoor fan will continue operating at low speed for a few minutes.

When X-FAN is OFF:

- After turning off the unit, the entire unit will shut down immediately.

Health

- Tap the Health icon to activate the Cold Plasma function.
- This function releases positive and negative ions that attach to airborne pollutants like dust and odors. These particles become heavier, causing them to drop out of the air or get trapped in filters more effectively.

	<p>UVC Lamp</p> <ul style="list-style-type: none"> Tap the UVC icon to activate the UVC Lamp function. <p><i>*The UVC Lamp function is only available on some models.</i></p>
	<p>Air</p> <ul style="list-style-type: none"> Tap the Air icon to activate the two-way ventilation function. <p><i>*The Two-Way Ventilation function is only available on some models.</i></p>
	<p>SE</p> <ul style="list-style-type: none"> Tap the SE icon to activate the Energy Saving functions. <p><i>*For models with AI-capability, this energy saving function may not be available as the unit itself already has AI-energy saving capability</i></p>
	<p>Sound</p> <ul style="list-style-type: none"> Tap the Sound icon to mute or unmute the operation sound of the unit when using the app. This feature allows for quieter operation, providing a more comfortable environment. <p>Please note that using the remote control or the unit's control panel will still produce sound feedback.</p>
	<p>Sleep</p> <ul style="list-style-type: none"> The Sleep Function on an air conditioner is an intelligent setting designed to provide maximum comfort and energy efficiency while you are asleep. Since your body temperature naturally drops during the night, the AC adjusts its output to match your metabolic changes. <div data-bbox="352 986 808 1066" style="border: 1px solid #ccc; padding: 5px; margin: 10px 0;"> <p style="text-align: center;">  Sleep  Traditional  </p> </div> <div style="display: flex; align-items: flex-start;"> <div data-bbox="221 1082 584 1136" style="border: 1px solid #ccc; padding: 5px; margin-right: 10px;"> <p>Expert </p> </div> <div data-bbox="613 1082 976 1465" style="border: 1px solid #ccc; padding: 10px;">  </div> </div> <p>Expert (Auto Sleep)</p> <ul style="list-style-type: none"> The air conditioner operates according to a factory-preset temperature curve designed for sleep cycles.

	<div data-bbox="218 119 576 175"> <p>Tradition <input checked="" type="radio"/></p> </div> <div data-bbox="212 183 526 215"> <p>Tradition (Normal Sleep)</p> </div> <div data-bbox="229 223 588 502"> <ul style="list-style-type: none"> This mode automatically adjusts the temperature based on the elapsed time to improve comfort. In Cool mode, the temperature increases by 1 degree after one hour and by 2 degrees after two hours. </div> <div data-bbox="610 119 974 502"> <table border="1"> <caption>Temperature vs Time (Tradition Mode)</caption> <thead> <tr> <th>Time (h)</th> <th>Temp (°C)</th> </tr> </thead> <tbody> <tr><td>1</td><td>26</td></tr> <tr><td>2</td><td>27</td></tr> <tr><td>3</td><td>27</td></tr> <tr><td>4</td><td>27</td></tr> <tr><td>5</td><td>27</td></tr> <tr><td>6</td><td>27</td></tr> <tr><td>7</td><td>27</td></tr> <tr><td>8</td><td>27</td></tr> </tbody> </table> </div> <hr/> <div data-bbox="218 518 576 574"> <p>DIY <input checked="" type="radio"/></p> </div> <div data-bbox="212 582 464 614"> <p>DIY (Custom Sleep)</p> </div> <div data-bbox="229 622 571 821"> <ul style="list-style-type: none"> This is a manual "Do-It-Yourself" mode where the user can program a custom temperature for each hour of an 8-hour sleep period. </div> <div data-bbox="610 518 974 901"> <table border="1"> <caption>Temperature vs Time (DIY Mode)</caption> <thead> <tr> <th>Time (h)</th> <th>Temp (°C)</th> </tr> </thead> <tbody> <tr><td>1</td><td>25</td></tr> <tr><td>2</td><td>26</td></tr> <tr><td>3</td><td>27</td></tr> <tr><td>4</td><td>27</td></tr> <tr><td>5</td><td>27</td></tr> <tr><td>6</td><td>27</td></tr> <tr><td>7</td><td>27</td></tr> <tr><td>8</td><td>26</td></tr> </tbody> </table> </div>	Time (h)	Temp (°C)	1	26	2	27	3	27	4	27	5	27	6	27	7	27	8	27	Time (h)	Temp (°C)	1	25	2	26	3	27	4	27	5	27	6	27	7	27	8	26
Time (h)	Temp (°C)																																				
1	26																																				
2	27																																				
3	27																																				
4	27																																				
5	27																																				
6	27																																				
7	27																																				
8	27																																				
Time (h)	Temp (°C)																																				
1	25																																				
2	26																																				
3	27																																				
4	27																																				
5	27																																				
6	27																																				
7	27																																				
8	26																																				
	<div data-bbox="184 933 397 965"> <p>Anti Direct Blow</p> </div> <div data-bbox="201 973 946 1077"> <ul style="list-style-type: none"> Adjust vent angle to avoid direct airflow in the Cool Mode. <ul style="list-style-type: none"> Anti Direct Blow 1: Avoid directly blow in close distance. Anti Direct Blow 2: Avoid directly blow in far distance. </div>																																				
	<div data-bbox="184 1101 425 1133"> <p>Temperature Units</p> </div> <div data-bbox="201 1141 974 1276"> <ul style="list-style-type: none"> Tap the Temperature Units icon to switch the temperature display between Celsius (°C) and Fahrenheit (°F). This allows you to choose your preferred unit of measurement for easier monitoring and adjustment. </div>																																				

Energy Consumption Monitoring

- This feature allows you to view the actual energy consumption of your air conditioner in kilowatt-hours (kWh).
- You can monitor usage in daily cumulative or monthly cumulative values, helping you track and manage your energy efficiency.

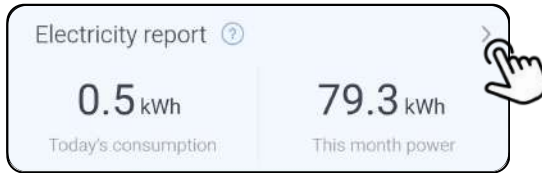

- Tap the Electricity Report panel to view graphical data of your energy consumption, displayed either in a graph or calendar format.



- You can review your previous daily or monthly consumption records.



- You may also set a target power value to monitor and identify the days when your energy usage exceeds the set limit.

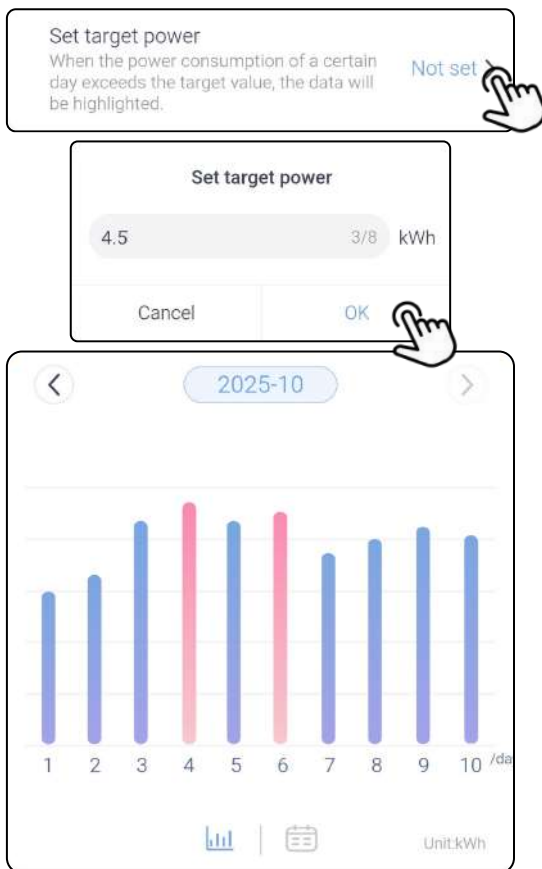

NOTE: The displayed energy consumption values are for reference purposes only and may vary from the actual measured data.

! DISCLAIMER

These buttons represent general features for Kolin air conditioners using the EWPE Smart app. Please note that available functions may vary; some buttons might not apply to your specific unit, while others may be added. Always refer to the interface within the app for the exact features supported by your model.



Schedule

When one or more devices are available, the Schedule function allows you to create either manual or automated commands for managing device/s operations.

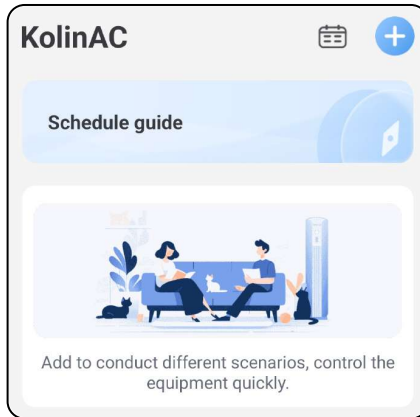

Creating Schedule

1 Tap "+" to add schedule



2 Choose Schedule-type

Manual schedule

Auto schedule

- **Manual Schedule** – Use this option if you want to manually trigger the command or action.
- **Auto Schedule** – Use this option to automatically trigger the command at a scheduled time.

3 Create schedule setting

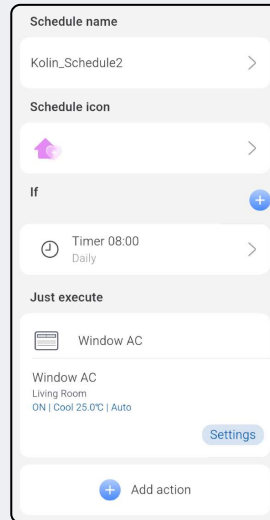

4 Save the schedule





Energy

This section summarizes the energy consumption of all units within your application that provide power data. It offers a centralized view of your total usage trends at a glance.



Compare Monthly Totals

- See if you used more or less electricity this month compared to the last. It's the easiest way to see if your bill is going up or down.

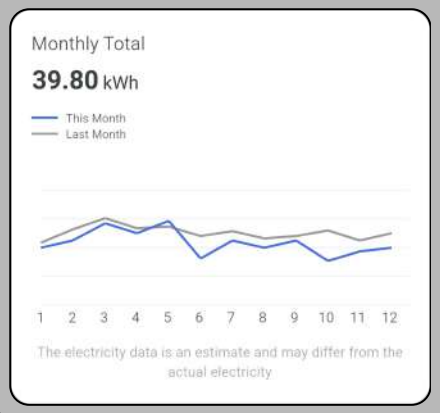

See Trends

(Weekly, Monthly, Yearly)

- Switch between weekly, monthly, or yearly charts. This helps you spot high-use patterns during summer heat, rainy seasons, or cold monsoons.

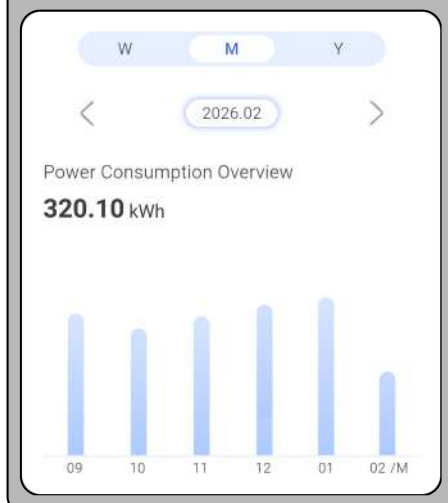



Energy

Monitor your Devices

- See exactly how much power each air conditioner uses. This shows you which room is using the most energy so you can adjust your cooling.

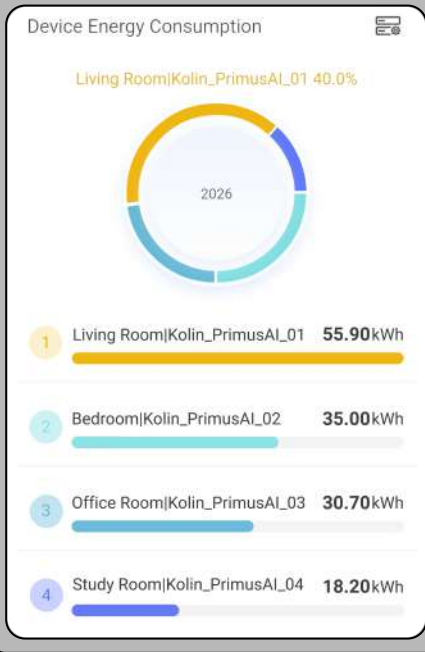

**Mobile data tracking provides an estimate only; please refer to your utility provider for official billing.*

Energy Saving Tips

- Discover how to stay comfortable while saving energy with these best practices.

< Energy Saving Tips

Comfortable Set Temperature

Summer: 26°C~28°C, Winter: 18°C~20°C, comfortable and energy-saving.

Reasonable Operation Method

After turning on the AC, you can run it at a higher fan speed for a period (e.g., about 30 minutes) to quickly lower the room temperature, then switch to a lower fan speed mode to maintain the temperature.

Good Usage Habits

It is recommended to regularly clean the filter, heat exchanger, or indoor/outdoor AC units to improve air quality and save electricity.

If going out for a short time (e.g., within 30 minutes) and the room has good thermal insulation (e.g., well-sealed doors and windows), you may leave the AC on to avoid frequent start-stop cycles that increase energy consumption; it is also recommended to raise the set temperature. If going out for a long time, or if the room has poor thermal insulation, it is recommended to turn off the AC when leaving.

During AC operation, it is recommended to close doors and windows to ensure good room sealing; in summer, use curtains or blinds to avoid direct sunlight and reduce room load.

Use the App remote control and timer functions reasonably to avoid unnecessary AC operation.

**These recommendations apply to standard conditions; please adjust your AC settings based on your personal comfort and environmental factors.*



Account

This page provides access to account details, home management settings, member invitations, general app configurations, and other related functions.

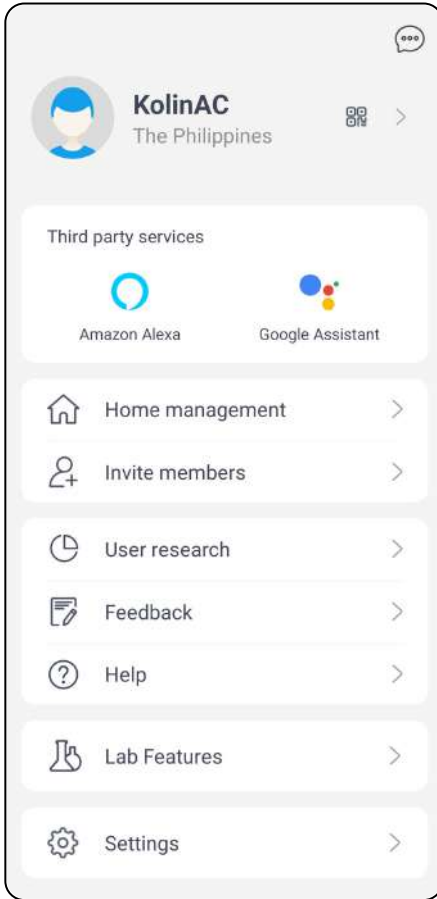

Messages

- It contains all messages by the system and device

Personal Information

- This section contains personal details such as the account avatar, nickname, username, and region.
- The QR code can be shared to allow others to join their family group.

Third-Party Services

- Link Amazon Alexa or Google Assistant to enable voice commands and additional smart control features.

Home Management

- This feature allows you to access the home management system, where you can share and control all devices connected to the app.

Invite Members

- It is used to scan a QR code or enter a username or email address to add a member to your family group.

The design and specifications are subject to change without prior notice for product improvement. Any updates to the manual will be uploaded to the Kolin official website, please check for the latest version.

If you have any concerns, please contact us at the following:

Customer hotline: **(02) 8852-6868**
Text hotline: **+63 917-881-8982**
Email: **service@kolinphil.com.ph**

Also, please like and follow us on social media accounts:

Facebook: kolinphilippines
Instagram: kolinphilippines
Youtube: kolinphilippines
Tiktok: kolinphilippines
Website: www.kolinphil.com.ph

KPI030626



Kolin Philippines International, Inc.

SERVICE CENTERS

BRANCH	ADDRESS	TEL. NO.
Bacolod	Door #A-2 & A-3 UTC Bldg., Alunan St., Brgy. 36, Bacolod City	(034) 466-9145
Cagayan De Oro	Door #3 De Oro Land Bldg., Julio Pacana St., Puntod, Cagayan de Oro City	(088) 557 - 7353
Cebu	Lot 758-B-1, P. Suico St. Upper Tabok, Mandaue City, Cebu	(032) 234 - 1844
Dagupan	Unit #1 107 Caranglaan District, Dagupan City, Pangasinan	(075) 529 - 0587
Davao	Blk 17 Lot 9, Calamansi St., Juna Subd., Matina, Davao City	(082) 272 - 0048
Iloilo	Door# 4,5 & 7, D' Appliance Arcade, South Fundidor, Molo, Iloilo City	(033) 337 - 5914
Pampanga	LRK Commercial Bldg., Jose Abad Ave., Lagundi, Mexico, Pampanga	(045) 455 - 2934

For More air conditioner tips, please like, share and follow us on our social media accounts:

Facebook : [kolinphilippines](#)
Instagram : [kolinphilippines](#)
Youtube : [kolinphilippines](#)
Tiktok : [kolinphilippines](#)
Website : www.kolinphil.com.ph

OFFICE

Kolin Bldg. 1854 Sta. Rita St.,
Guadalupe Nuevo, Makati City, 1212
Service Hotline: (632) 8852 - 6868

PLANT

Blk 3 Lot 5, Main Drive First Cavite
Industrial Estate, Langkaan 1,
Dasmariñas City, Cavite
Tel. No.: (046) 402-0793